

Schaerer Coffee Vito

Model Freshmilk SCV FM CT1/S-FTU/G2MA/DM/KE
(coffee / hot water / milk / chocolate)

March 2009



Basic configuration

Spouts: coffee / hot water	1 / 1
Boilers: coffee and hot water (2kW) / steam (2kW)	1 / 1
Grinders / DECAF function	2 / 1
Programmable product selection	up to 15 products
Bean hopper / Water supply	each 1.1 kg / Aquaflex
Powder-System for Choco	Choco (1 type of chocolate powder) or Twin Choco (2 types of chocolate powder)
Illuminated panel	Colour of your choice or continually changing

Connections

Voltage / power / fuse protection	230/220/210 VAC, 2.2/1.8 kW, 10 A
Water connection / water outlet	G ½ "max 3 bar / Ø 56mm
Water hardness	5°-7° dh / 8°-12° fh

Dimensions

Width / depth / height	330 / 583 / 814 mm
Weight	about 36 kg

Output per hour (approximate)

Espresso (cup of 50 - 60 ml)	100
Coffee (cup of 120 ml)	80
Cappuccino (cup of 180ml) / Latte Macchiato (cup of 200ml)	60 / 40
Moccaccino (cup of 180ml) / Hot chocolate (cup of 180ml)	60 / 60

Options

- Chute for coffee grounds under counter
- Cup warmer or Cup & Cool
- Connection to all commercial invoicing systems

Dimensions

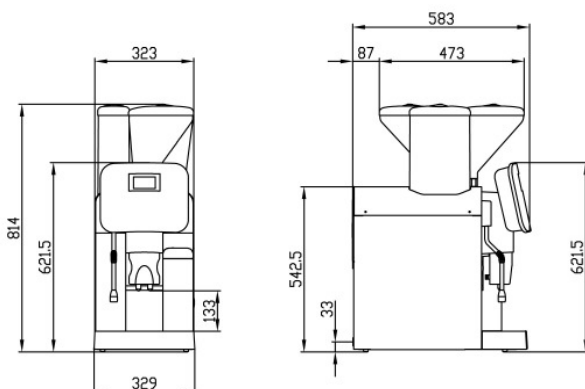

Illustration /configuration may vary from offered machines.

Colours

Illustrations may not reflect actual colour

 Kenya, black

Partner:

57 Años
LA CASA DE LA GRECA
Lideres en Calidad
Calle 69 No. 11A-98 PBX 2100 800
Bogotá, D.C. COLOMBIA, S.A.
WWW.LACASADELAGRECA.COM

M. Schaerer Ltd.

Gewerbstrasse 15
CH - 3302 Moosseedorf
Phone +41 (0)31 858 51 11
Fax +41 (0)31 858 51 40
info@schaerer.com
www.schaerer.com

schaerer
coffee comes to life